

## Description

Fallprotec has designed fasteners to allow the fixing of Securope life line on fragile structure like standing seam roof. Securope fixing assembly to attach life line on standing seam roof, without piercing the panel, does not jeopardize the integrity of the roof.

## Technical specifications

Delivered with an installer and user manual.

Material: Aluminium and stainless steel

Load per clamp 3KN

 Compliant with EN 795:2012  
C EN/TS 16415:2013  
MADE IN EU



## Advantages

- For 4 users
- Energy and dilatation absorbing
- No drilling of the panels needed

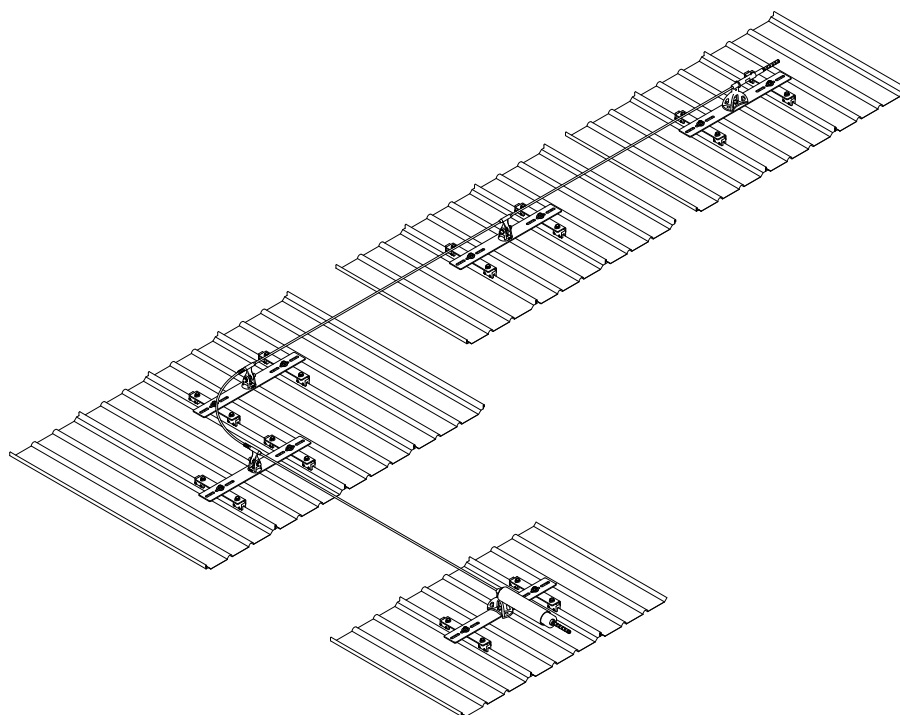

## Lifeline on standing seam

Fixation through clamps

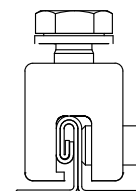

## Securope on standing seam roof

# FALLPROTEC

December 2019

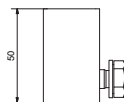

**Clamp S5-E** for standing seam double folds, groove's width 7mm

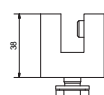
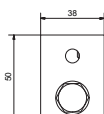

**Clamp S5-S** for standing seam double folds, groove's width 14mm

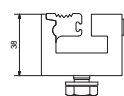
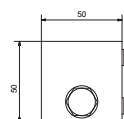

**Clamp S5-T** for standing seam with double folds shaped "T" or "L"

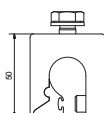
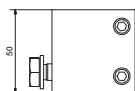
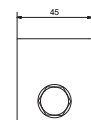

**Clamp S5-Z** for standing seam with bulb shape

## Applications

